



71 Ovaltine Court Ovaltine Drive

Kings Langley, WD4 8GY

£1,350

SKIM STONES ALONG THE CANAL! - Come along & view this stunning two bedroom refurbished second floor flat, The large living space is bright and airy and benefits from a stylish & modern Kitchen Area. The main bedroom is generous in size with a stunning en-suite, and the second bedroom is a good size double also. Within walking distance to Kings Langley train station & the historic village High Street, and offering one undercover parking space.

- Stunning Two Double Bedroom Apartment
- MODERN Bathroom, en Suite & Kitchen
- Located on the banks of the Grand Union canal
- 2nd Floor Apartment with Lift Access
- Philips 'Hue' Remote Control Lighting
- Kitchen with Built in Appliances
- Living Space with Juliette Balcony
- Council Tax Band D
- Holding Deposit £288.00

Viewing

Please contact our Bovingdon Office on 01923262666 if you wish to arrange a viewing appointment for this property or require further information.



2



2



1



B

Floor Plan

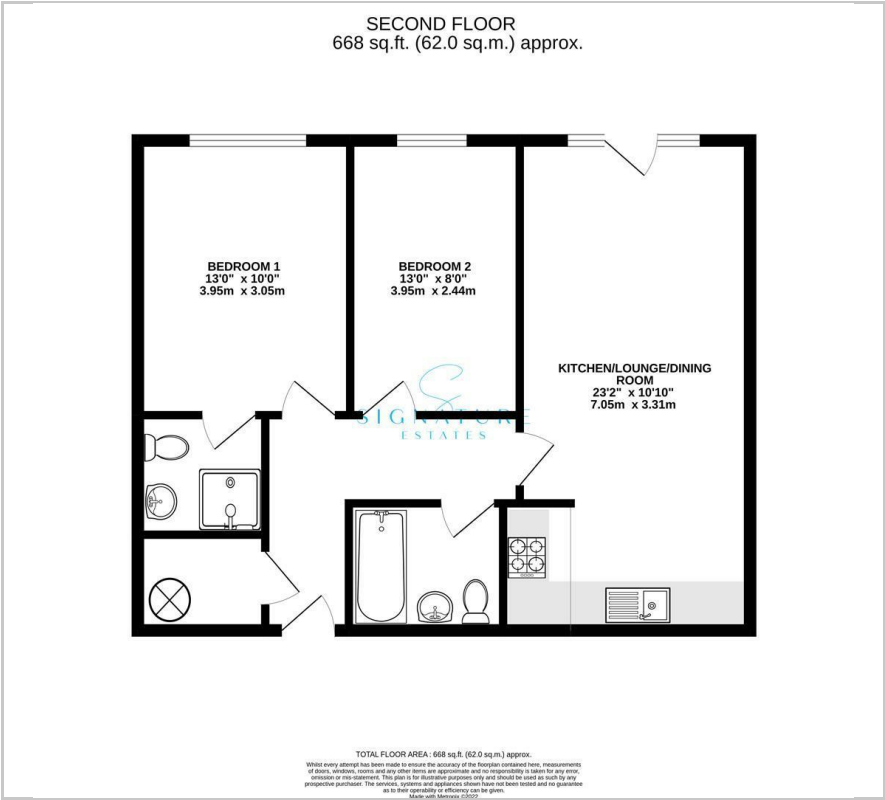

Area Map

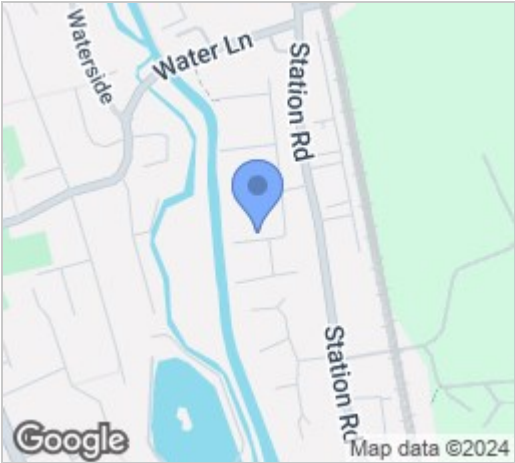

Energy Efficiency Graph

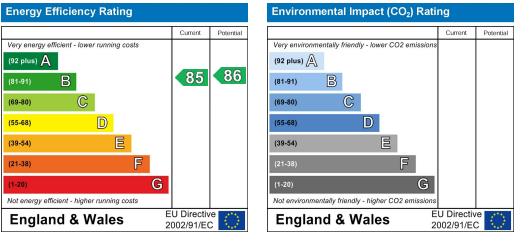

These particulars, whilst believed to be accurate are set out as a general outline only for guidance and do not constitute any part of an offer or contract. Intending purchasers should not rely on them as statements of representation of fact, but must satisfy themselves by inspection or otherwise as to their accuracy. No person in this firms employment has the authority to make or give any representation or warranty in respect of the property.

10 High Street, Bovingdon, Hertfordshire, HP3 0HG

T: 01923262666 | E: bovingdon@signatureestates.co.uk | www.signatureestates.co.uk